

NU 1048 ML

Dimensions

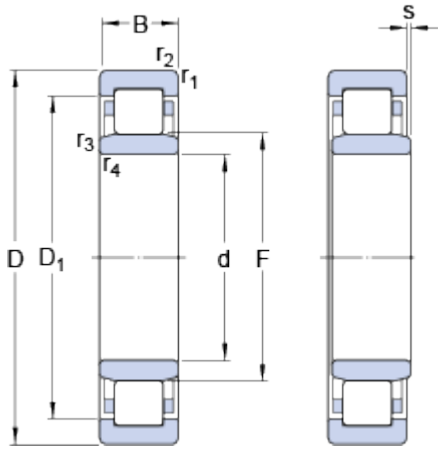

d		240	mm
D		360	mm
B		56	mm
D ₁	≈	316.2	mm
F		270	mm
r _{1,2}	min.	3	mm
r _{3,4}	min.	3	mm
s		7.5	mm

Abutment dimensions

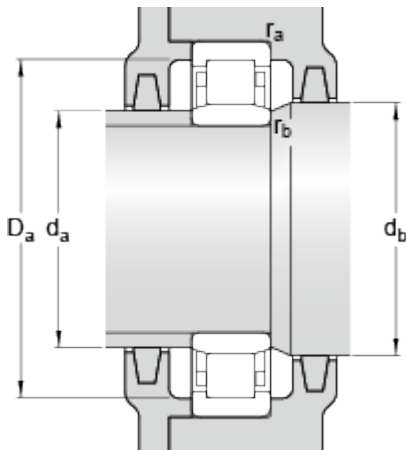

d _a	min.	252	mm
d _a	max.	266	mm
d _b	min.	274	mm
D _a	max.	348	mm
r _a	max.	2.5	mm
r _b	max.	2.5	mm

Calculation data

Basic dynamic load rating	C	523	kN
Basic static load rating	C ₀	800	kN
Fatigue load limit	P _u	78	kN
Reference speed		2000	r/min
Limiting speed		3000	r/min
Calculation factor	k _r	0.15	

Mass

Mass bearing	19.35	kg
--------------	-------	----

Appropriate products

Angle ring	HJ 1048
------------	---------

